

Queensland Nepalese Cultural Centre (QNCC)

our identity, our pride



QNCC

Queensland Nepalese Cultural Centre (QNCC) is a community initiative to create a common venue for the Nepalese community members for social and cultural/religious gatherings, and events. The centre will also serve as an information hub for Nepal. This will be an iconic place, not only exhibiting our rich cultural heritage, but also promoting our motherland in Australia. This will be a true gift to our future generation as this will connect the generations to come to our very roots.

History

The need for a Nepali community/cultural centre was long realised in 2006, when the Nepalese community in Queensland started growing. With the growing Nepali population in Queensland, and the desperate need for a place which we could proudly say our own, this gained great momentum in 2015, which was further revitalised in 2017. At this stage, local Nepalese community organisations such as NAQ and NRNA Australia were striving to build a Nepalese community centre including a temple to enhance the cultural engagement and spiritual experience to serve the diverse Nepalese community in Queensland. A number of public discussion forums were held and QNCC was officially established in 2018.

Community Involvement

The establishment of the cultural centre is a highly ambitious and a dream project. It requires a great deal of resources that include money as well as the voluntary support of the community members in every aspect of planning, development, operation and maintenance. Without a unified voice and a cohesive engagement, it is almost impossible to materialise our dream.

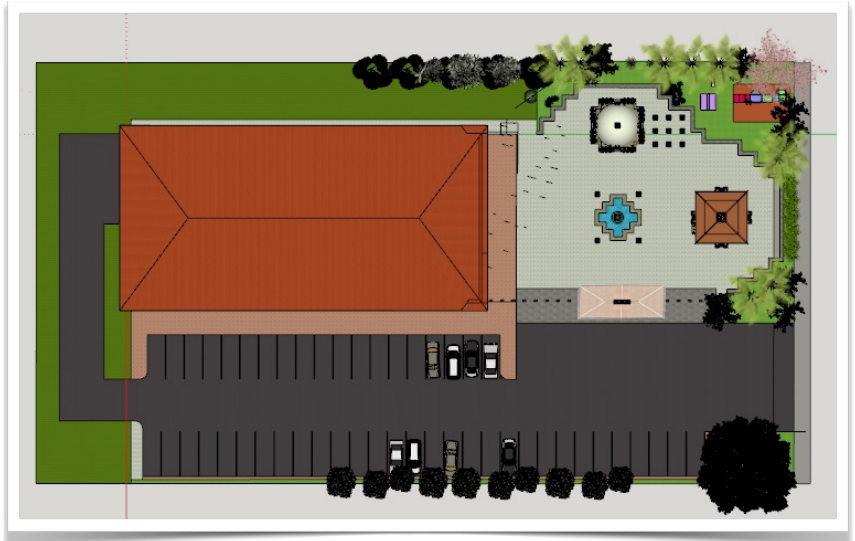

Our Plan

Masterplan

When fully completed, Queensland Nepalese Cultural Centre will have the following components:

- A community hall suitable for functions/gathering;
- Replicas of Pashupatinath temple and Swyambhunath temple or Bouddha stupa suitable for worshipping in small groups;
- Small office rooms for QNCC and other Nepalese associations such as NAQ and NRNA actively involved in the project;
- Parking, toilets, and other necessary amenities;
- Specially designed and decorated front courtyard;
- The entire venue (both inner and outer) will be decorated to represent Nepali art, culture and tradition.

The very first step towards this is to secure a suitable land in the vicinity of Brisbane, the state capital of Queensland. A land suitable for the centre as well as with the right zoning appears to be difficult to find, especially in areas close to Brisbane CBD. We have been searching for a suitable land for some time now, and it is likely that we might find a suitable land in Moreton Bay, Logan or Ipswich city council areas. The search is ongoing. We are also communicating with the city councils to see if any support would be available.



Concept design: Kamal Shrestha/Swasti Shrestha



Membership Structure

The membership is the backbone of this initiative for two reasons: (1) it is a means of raising the required funds, and (2) it provides an opportunity of owning the concept to community members.

The membership structure is set out in the QNCC constitution. Three membership categories are available:

- Individual life member - \$1,000
- Family life member - \$1,500
- Organisational member (NAQ and NRNA Australia QLD SCC at this stage)

Membership application could be initiated by paying \$200 upfront. The rest of the membership fee could be paid within 12 months. However, the membership application could only be approved after making the full amount payment.

All the life members will have some privileges and will be acknowledged by permanently displaying their names on a suitable place of the centre.

Governance

QNCC is incorporated under the Association Incorporation Act 1981 of the State of Queensland as a not-for-profit association. The operation of the association is governed by its constitution.

A management committee (MC) is constituted during AGM as per the constitution, and the term of MC is of two years. Only the life members are eligible to hold the positions in the MC. The constitution has a provision for NRNA Australia QLD SCC and NAQ representation in the MC. The finances of the associations are kept as per the provisions in the constitution and are audited annually. The audit report is submitted to the QLD government at the end of each financial year.

Development Stages

As per the current master plan (tentative), we require a minimum of 4,000 m² of land to accommodate all the structures and amenities. However, without having a knowledge of the location, zoning, shape and size of the land, it is hard to estimate the exact land requirement and the overall cost. Nevertheless, the cost is expected to run in millions. Considering the current constraints in terms of the budget, a staged development of the centre is planned. How fast we can complete each of these stages would depend upon how much fund and resources we could raise in due course. Tentatively, we plan to develop the centre in the following six stages:

- **Stage 1:** Land purchase
- **Stage 2:** DA approval
- **Stage 3:** Replicas of Pashupatinath and Swyambhunath temples with basic amenities such as parking space and toilets
- **Stage 4:** A covered area with the concrete floor as the initial stage of the community hall to serve as a temporary function area
- **Stage 5:** Completion of the community hall with office rooms
- **Stage 6:** Proper parking space and the specially designed front courtyard

A management plan will be developed in consultation with all the stakeholders to look after the facilities, when completed in a sustainable way.

Funding Options

While we aim for a multi-million dollar project, we have got about \$300,000 in our bank account (collected as membership fee and donation) at the moment and there is another \$50,000 pledged donation, which is yet to be collected.

Under the current scenario, co-investment with potential investors (among the QNCC members, details yet to be worked out) appears to be a logical way to secure a potential land, and this would require the investment of at least \$700,000 from QNCC. Therefore, we urgently need to increase our membership number 4 times from current 90 to about 360.

We are currently focusing on membership drive to collect sufficient funds to purchase a suitable land. After this, we will start collecting funds for the building through the following activities in close collaboration with NAQ and NRNA Australia: a continuing membership drive, collecting donations from different sources, large fundraising events such as maha-yagya, and approaching for funding support from the government.

Decision Making Process

The tentative plan presented here serves as a guide for us, and it is subject to changes. All the major decisions in relation to the development of the plan and its execution are made by the majority of financial members in an AGM or specially convened meeting. These include the location of site, major fund raising efforts, details of the plan and the execution phases. The MC, which is elected by the members, will be responsible for making day to day decisions and facilitating the operational plan and will act as a co-ordinating body.



We look forward to your involvement and support. For further information, please visit: <http://www.qncc.org.au>.

Contact: Dr. Keshab Sharma (President), email: ec.qncc@gmail.com, mobile: 04 3033 9989.